

» **DESPIECE**

STR2-6-1127A
STR2-10-1127A
STR2-10-1230A

MOTOBOMBA SUMERGIBLE PARA LODOS

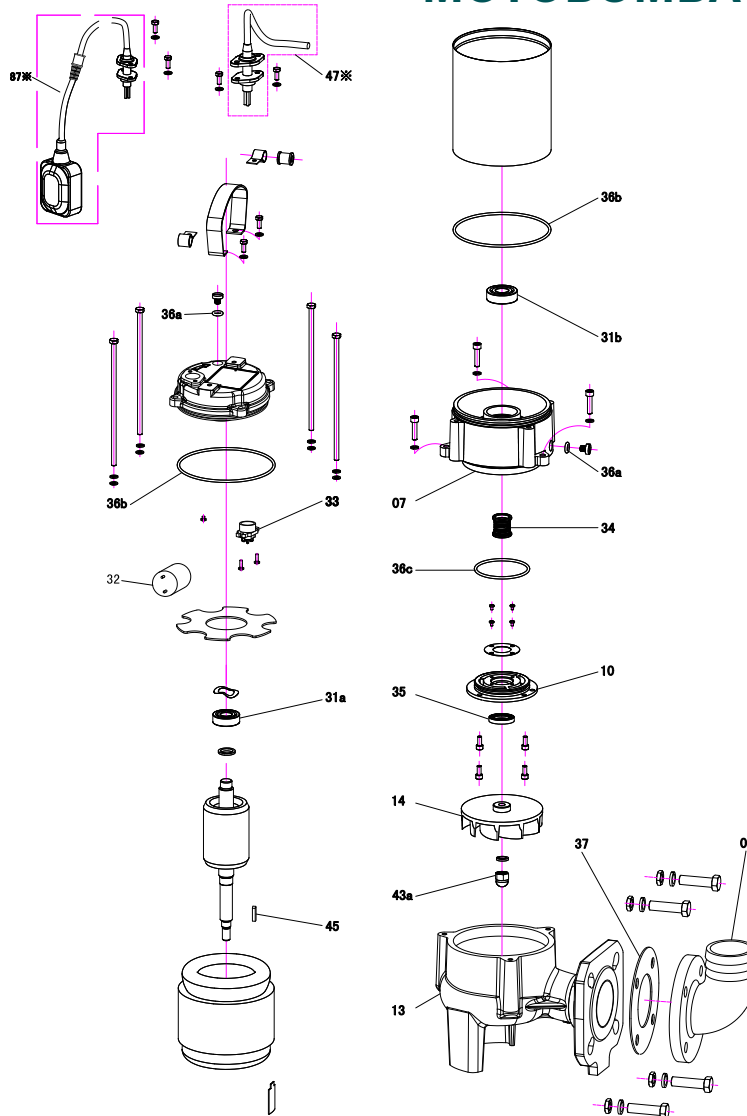

» **TABLA DE ESPECIFICACIONES**

POSICIÓN	DESCRIPCIÓN	STR2-6-1127A	STR2-10-1127A	STR2-10-1230A	CODIGO
1	BRIDA STR2 6-1127/10-1230A	✓	✓	✓	R-STR2N/6/10-BRD
7	CAMARA DE ACEITE STR2 6-1127/1230	✓	✓	✓	R-STR2N/6/10-CDA
10	PLATO PORTA SELLO STR2 6-1127/10-1230	✓	✓	✓	R-STR2N/6/10-PPS
13	CUERPO DE BOMBA STR2 6-1127/10-1230	✓	✓	✓	R-STR2N/6/10-CB
14	IMPULSOR STR2 6-1127 IMPULSOR STR2 10-1127/1230	✓	✓	✓	R-STR2N/6-IMP R-STR2N/10-IMP
32	CAPACITOR STR2 20UF CAPACITOR STR2 50UF	✓	✓	✓	R-STR2N-CAP20UF R-STR2N-CAP50UF
33	KLIXON STR2 15-1230 KLIXON STR2 10-1127A KLIXON STR2 10-1230A	✓	✓	✓	R-STR2N/15-KLX R-STR2N/10-KLX R-STR2N/10A-KLX
34	SELLO MECANICO STR2 15-1127/20-1230	✓	✓	✓	R-STR2N/15/20-SM
35	RETEN STR2 15-1127/20-1230	✓	✓	✓	R-STR2N/15/20-RTN
36	KIT O-RING 6-1127/10-1230	✓	✓	✓	R-STR2N/6/10-ORG
37	EMPAQUE DE BRIDA 6-1127/10-1230	✓	✓	✓	R-STR2N/6/10-EDB
43a	TUERCA DE IMPULSOR 6-1127/10-1230	✓	✓	✓	R-STR2N/6/10-TDI
45	CUÑA 6-1127/10-1230A	✓	✓	✓	R-STR2N/6/10-CUÑA
47	CABLE CONECTOR STR2 15-1127 CABLE CONECTOR STR2 15-1230	✓	✓	✓	R-STR2N/15/127-CC R-STR2N/15/230-CC
87	FLOTADOR STR2 6-1127 A 20-1230	✓	✓	✓	R-STR2N-FLT

» **DESPIECE**

STR2-15-1127A
STR2-15-1230A
STR2-20-1230A

MOTOBOMBA SUMERGIBLE PARA LODOS

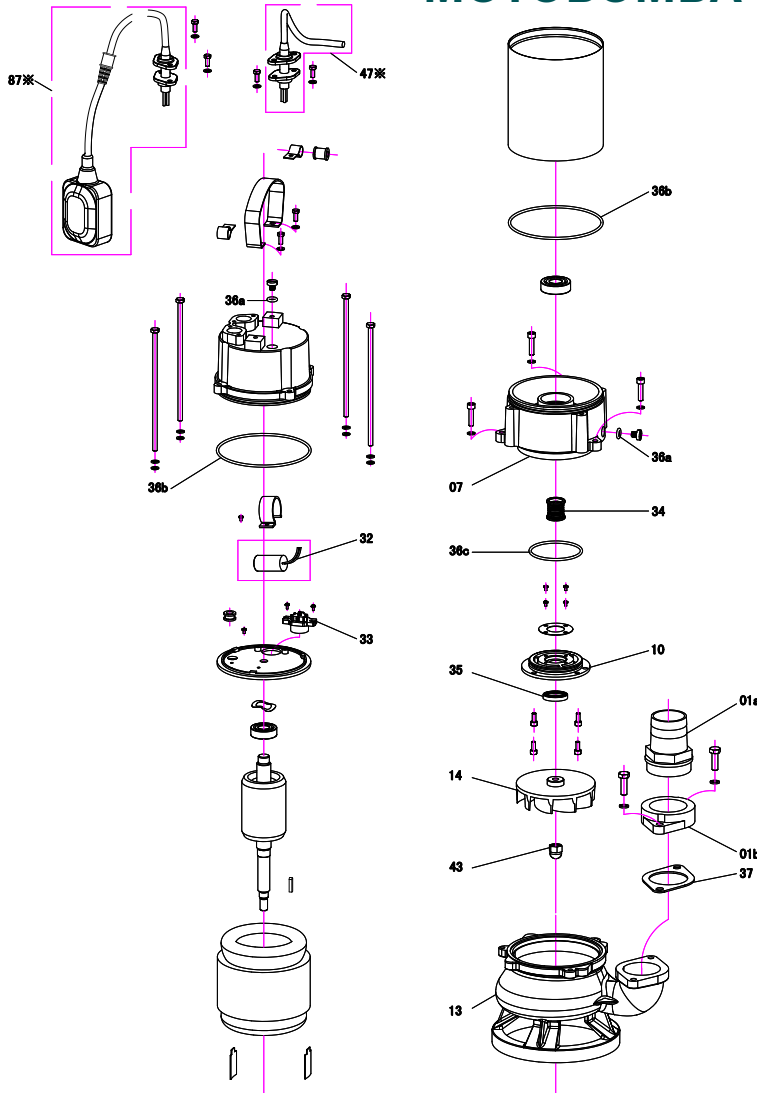

» **TABLA DE ESPECIFICACIONES**

POSICIÓN	DESCRIPCIÓN	STR2-15-1127A	STR2-15-1230A	STR2-20-1230A	CODIGO
01a	COPLÉ DE MANGUERA STR2 15-1127/20-1230	✓	✓	✓	R-STR2N/15/20-CDM
01b	BRIDA STR2 15-1127/20-1230	✓	✓	✓	R-STR2N/15/20-BRD
7	CAMARA DE ACEITE STR2 15-1127/20-1230	✓	✓	✓	R-STR2N/15/20-CDA
10	PLATO PORTA SELLO STR2 15-1127/20-1230	✓	✓	✓	R-STR2N/15/20-PPS
13	CUERPO DE BOMBA STR2 15-1127/20-1230	✓	✓	✓	R-STR2N/15/20-CB
14	IMPULSOR STR2 15-1127/1230	✓	✓		R-STR2N/15-IMP
	IMPULSOR STR2 20-1230			✓	R-STR2N/20-IMP
	CAPACITOR STR2 70UF	✓			R-STR2N-CAP70UF
32	CAPACITOR STR2 35UF		✓		R-STR2N-CAP35UF
	CAPACITOR STR2 30UF			✓	R-STR2N-CAP30UF
33	KLIXON STR2 15-1127/20-1230	✓		✓	R-STR2N/15/20-KLX
	KLIXON STR2 15-1230		✓		R-STR2N/15-KLX
34	SELLO MECANICO STR2 15-1127/20-1230	✓	✓	✓	R-STR2N/15/20-SM
35	RETEN STR2 15-1127/20-1230	✓	✓	✓	R-STR2N/15/20-RTN
36	KIT DE O-RING STR2 15-1127/20-1230	✓	✓	✓	R-STR2N/15/20-ORG
37	EMPAQUE DE BRIDA STR2 15-1127/20-1230	✓	✓	✓	R-STR2N/15/20-EDB
43	TUERCA DE IMPULSOR STR2 15-1127/20-1230	✓	✓	✓	R-STR2N/15/20-TDP
	CABLE CONECTOR STR2 15-1127	✓			R-STR2N/15/127-CC
47	CABLE CONECTOR STR2 15-1230		✓		R-STR2N/15/230-CC
	CABLE CONECTOR STR2 20-1230			✓	R-STR2N/20-CC
87	FLOTADOR STR2 6-1127 A 20-1230	✓	✓	✓	R-STR2N-FLT